

CAR WASH
TRANSMISSIONS

EN

uni CSB

The ultimate carwash belt

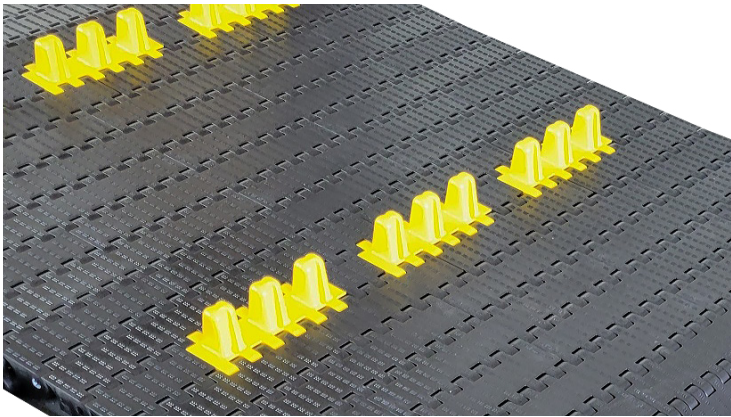

Unique Features Resulting in Longer Lifetime and Lower Cost Per Wash



8mm stainless-steel pins:

Lowering pin wear and subsequent belt elongation. Higher load capacity and less belt stretch.

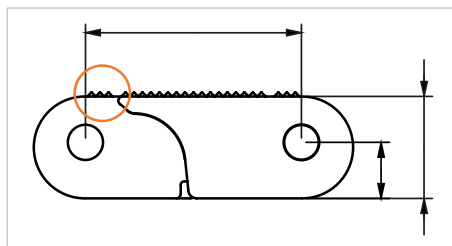

Off-set pin position to the top surface:

To allow more belt thickness wear without experiencing sprocket engagement problems.

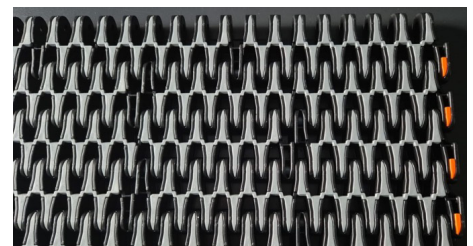

To allow more belt thickness wear without experiencing sprocket engagement problems.

Less belt thickness wear and less sliding sheet wear.



Hinge driven sprockets engaging in better chordal motion into "open" pockets able to be flushed and cleaned:

Better sprocket engagement and less sprocket wear.

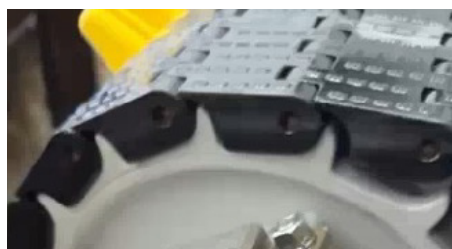

2" pitch belt having more teeth on same sprocket diameter:

Lower chordal effect reducing pin-hole and pin cam-shafting wear.

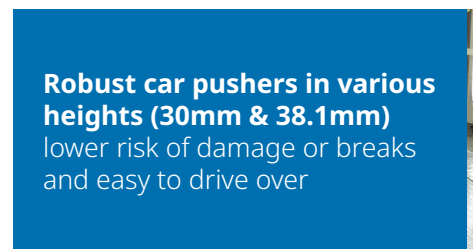

Robust car pushers in various heights (30mm & 38.1mm)

lower risk of damage or breaks and easy to drive over

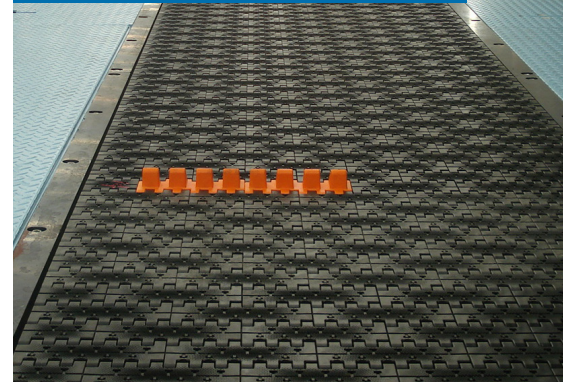

Read more
about carwash
solutions



uni AMB

premium and heavy load alternative for express wash

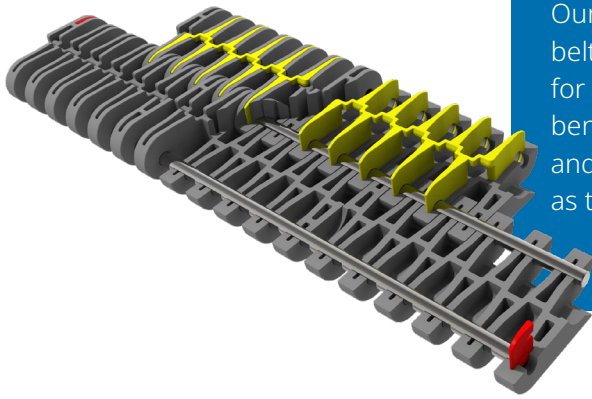

Our strongest (180,000 N/m) belt ever! The ultimate solution for higher loads. uni AMB benefits from the same unique and patented design principles as the uni CSB.



also the perfect Plastic Modular Belt for Detailing conveyors

Detailing conveyors where the interior cleaning takes place don't require the same high load and high wear resistance belts as we recommend for express wash.

The uni ACB is the ideal belt used in the more friendly conditions, and it still benefits from the same unique and patented features as the uni CSB & AMB but in a lighter and lower cost version.

In addition to this, the uni ACB also comes with electric conductive inserts to avoid any electro-static discharge risks of customers or operators.



**The local partner of choice
for sustainable conveyor belting solutions
- around the globe.**



Scan the QR code
and find your local
contact

Ammeraal Beltech
P.O. Box 38
1700 AA Heerhugowaard
The Netherlands

T +31 (0)72 575 1212

www.ammeraalbeltech.com